

**NOTE:**  
DISTANCES SHOWN ON THIS PLAN ARE  
IN METRES AND CAN BE CONVERTED  
TO FEET BY DIVIDING BY 0.3048.

**BEARING NOTE:**  
BEARINGS ARE ASTRONOMIC, DERIVED FROM THE NORTHERLY LIMIT OF  
PART 2, PLAN 45R-283 SHOWN THEREON TO HAVE A BEARING OF  
N70°33'00"E.

SKETCH SHOWING  
SHOWING PROPOSED ADDITION  
# 165 MELODY BAY ROAD  
MUNICIPALITY OF TRENT LAKES  
COUNTY OF PETERBOROUGH



SCALE: 1 : 250  
© COPYRIGHT 2022

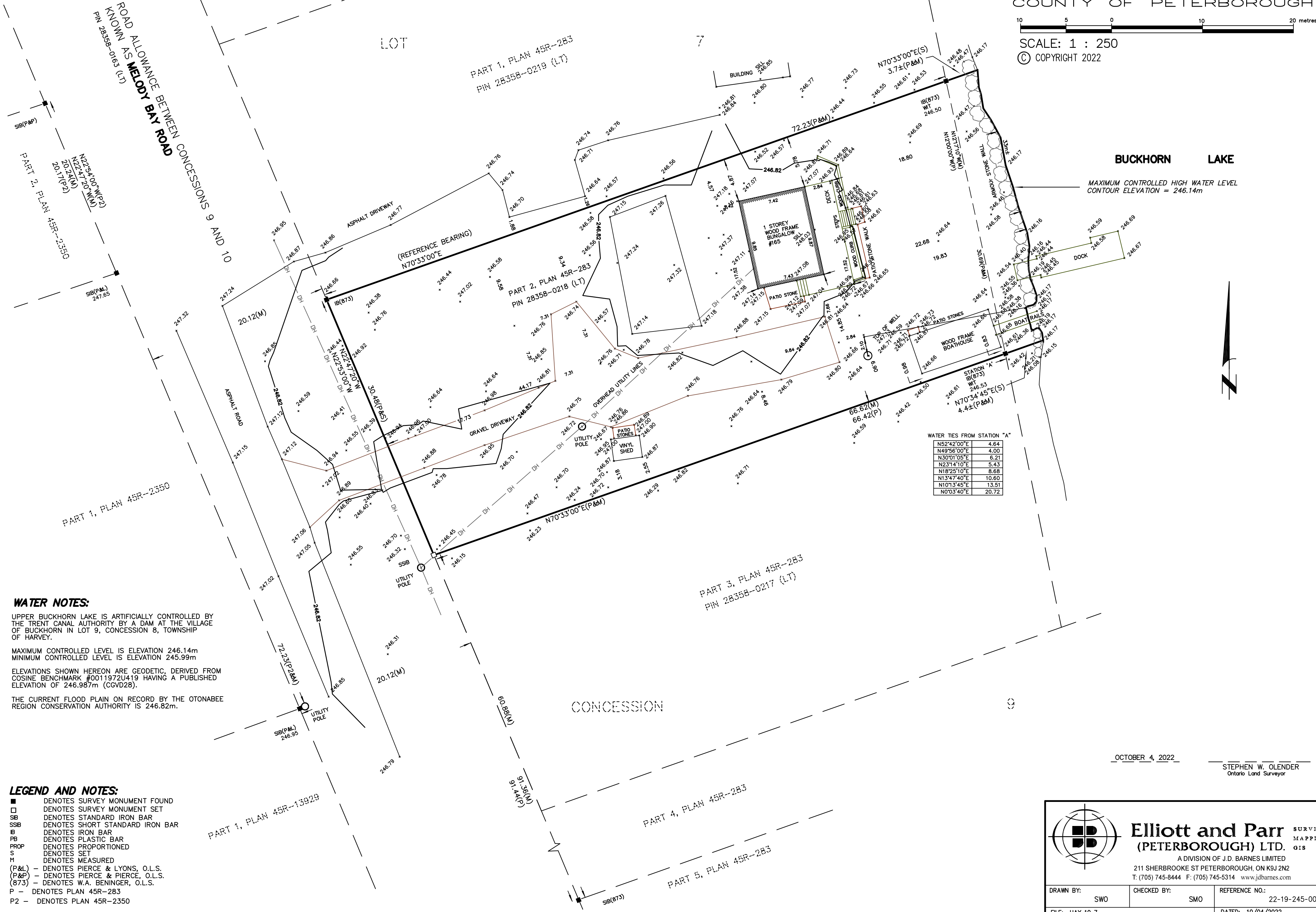

BUCKHORN LAKE

MAXIMUM CONTROLLED HIGH WATER LEVEL  
CONTOUR ELEVATION = 246.14m

WATER TIES FROM STATION "A"

N52°42'00"E	4.64
N49°56'00"E	4.00
N30°01'05"E	6.21
N23°14'10"E	5.43
N18°25'10"E	8.68
N13°47'40"E	10.60
N10°13'45"E	13.51
N0°03'40"E	20.72

**WATER NOTES:**  
UPPER BUCKHORN LAKE IS ARTIFICIALLY CONTROLLED BY  
THE TRENT CANAL AUTHORITY BY A DAM AT THE VILLAGE  
OF BUCKHORN IN LOT 9, CONCESSION 8, TOWNSHIP  
OF HARVEY.

MAXIMUM CONTROLLED LEVEL IS ELEVATION 246.14m  
MINIMUM CONTROLLED LEVEL IS ELEVATION 245.99m

ELEVATIONS SHOWN HEREON ARE GEODETIC, DERIVED FROM  
COSINE BENCHMARK #0011972U419 HAVING A PUBLISHED  
ELEVATION OF 246.987m (CGVD28).

THE CURRENT FLOOD PLAIN ON RECORD BY THE OTONABEE  
REGION CONSERVATION AUTHORITY IS 246.82m.

**LEGEND AND NOTES:**  
■ DENOTES SURVEY MONUMENT FOUND  
□ DENOTES SURVEY MONUMENT SET  
SB DENOTES STANDARD IRON BAR  
SSIB DENOTES SHORT STANDARD IRON BAR  
IB DENOTES IRON BAR  
PB DENOTES PLASTIC BAR  
PROP DENOTES PROPORTIONED  
S DENOTES SET  
M DENOTES MEASURED  
(P&L) - DENOTES PIERCE & LYONS, O.L.S.  
(P&P) - DENOTES PIERCE & PIERCE, O.L.S.  
(873) - DENOTES W.A. BENINGER, O.L.S.  
P - DENOTES PLAN 45R-283  
P2 - DENOTES PLAN 45R-2350

OCTOBER 4, 2022

STEPHEN W. OLENDER  
Ontario Land Surveyor

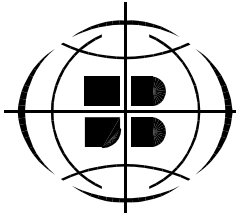

**Elliott and Parr**  
(PETERBOROUGH) LTD.

SURVEYING  
MAPPING  
GIS

A DIVISION OF J.D. BARNES LIMITED  
211 SHERBROOKE ST PETERBOROUGH, ON K9J 2N2  
T: (705) 745-8444 F: (705) 745-5314 www.jdbarnes.com

DRAWN BY: SWO	CHECKED BY: SMO	REFERENCE NO.: 22-19-245-00SITE
FILE: HAY 10-7	DATED: 10/04/2022	