

**The Corporation of the
Municipality of Trent Lakes**

By-law No. B2024-065

**A By-law to Amend By-law B2014-070 Otherwise Known as
“The Municipality of Trent Lakes Comprehensive Zoning By-
law”**

Whereas the Municipality of Trent Lakes is in receipt of an application (24-07) to amend By-law No. B2014-070, as amended;

And Whereas pursuant to Section 34 of the *Planning Act*, R.S.O. 1990, as amended, By-laws may be passed by Council of municipalities for prohibiting or regulating the use of land and the erection and use of buildings or structures within the Municipality;

And Whereas the Council of the Corporation of the Municipality of Trent Lakes held a public meeting as required by Section 34(12) of the *Planning Act*;

And Whereas the matters herein are in conformity with the Official Plan of the Municipality of Trent Lakes, as amended;

Now Therefore the Council of the Corporation of the Municipality of Trent Lakes enacts as follows:

1. Schedule “A” Map 4 of By-law No. B2014-070 is amended by changing the zone category of those lands described legally as Lot 23, Concession 5 and Part Road Allowance in Front of Lot 23 Concession 5, Part 1 & Part 2 Plan 45R-14893 (Harvey), within the Municipality of Trent Lakes and having Roll No. 1542-020-301-25300, from “Shoreline Residential – Private Access (SR-PA) Zone” to “Shoreline Residential – Private Access - 126 (SR-PA-126) Zone” as shown on Schedule “A-1” attached hereto and forming part of this By-law.
2. Section 9 “Shoreline Residential – Private Access (SR-PA) Zone” is hereby amended by adding a new subsection, namely “9.6.126 – Shoreline Residential – Private Access - 126 (SR-PA-126) Zone” which shall read as follows:

“9.6.126 Shoreline Residential – Private Access - 126 (SR-PA-126) Zone

No person shall within any Shoreline Residential – Private Access (SR-PA-126) Zone, described legally as Lot 23, Concession 5 and Part Road Allowance in Front of Lot 23 Concession 5, Part 1 & Part 2 Plan 45R-14893 (Harvey), within the Municipality of Trent Lakes, use any land or erect, alter or use any building or structure except in accordance with the following provisions:

9.6.126.1 Permitted Uses

All of the permitted uses within the Shoreline Residential-Private Access (SR-PA) Zone shall apply to lands zoned Shoreline Residential – Private Access -126 (SR-PA-126).

9.6.126.2 Special Regulations for Uses Permitted in Section 9.6.126.1

All of the provisions and regulations of the Shoreline Residential – Private Access (SR-PA) Zone shall apply with the following exceptions:

- (i) Minimum Water Yard Setback (Dwelling NW Corner): 12.73 m

(ii) Minimum Water Yard Setback (Dwelling NE Corner):	8.96 m
(iii) Minimum Water Yard Setback (Deck, NE Corner):	7.23 m
(iv) Minimum Water Yard Setback (Deck, NW Corner):	12.0 m
(v) Minimum Water Yard Setback (Septic, NW Corner):	16.31 m
(vi) Minimum Interior Side Yard Setback (Dwelling, NW Corner):	9.27 m
(vii) Minimum Interior Side Yard Setback (Dwelling, SW Corner):	6.67 m
(viii) Minimum Exterior Side Yard Setback (Dwelling SW Corner):	8.39 m
(ix) Minimum Exterior Side Yard Setback (Attached Garage):	3.20 m
(x) Minimum Interior Side Yard Setback (Guest Cabin):	1.52 m
(xi) Minimum Exterior Side Yard Setback (Guest Cabin):	3.20 m
(xii) Maximum Total Floor Area (Guest Cabin):	41.53 m ²
(xiii) Maximum Ground Floor Area (Dwelling):	183.25 m ²
(xiv) Maximum Total Floor Area (Dwelling):	281 m ²
(xv) Maximum Ground Floor Area (Attached Deck):	54.5 m ²
(xvi) Maximum Ground Floor Area (Attached Covered Unenclosed Breezeway):	10.22 m ²
(xvii) Maximum Total Floor Area (Attached Garage):	44.65 m ²
(xviii) Maximum Lot Coverage:	15%

For the purpose of the SR-PA-126 Zone, only one dwelling unit is permitted and the guest cabin shall not have a deck or loft or be connected to any septic or water supply system. For the purpose of ground floor area, the 35.77 m² screened in porch has been added to the total ground floor area of the dwelling.

3. This By-law shall come into force on the date that it is passed by the Council of the Municipality of Trent Lakes, subject to the provisions of Section 34 of the *Planning Act*, R.S.O. 1990, as amended.
4. The Clerk is hereby authorized and directed to proceed with the giving of notice under Section 34(18) of the *Planning Act*, R.S.O. 1990, as amended.

Read a first and second time this 6th day of August, 2024.

Read a third and final time this 6th day of August, 2024.

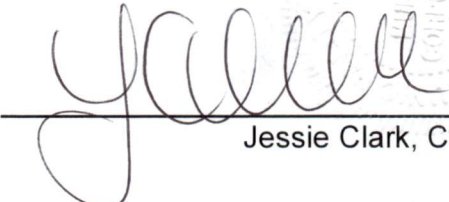

 Terry Lambshead, Mayor

 Jessie Clark, Clerk

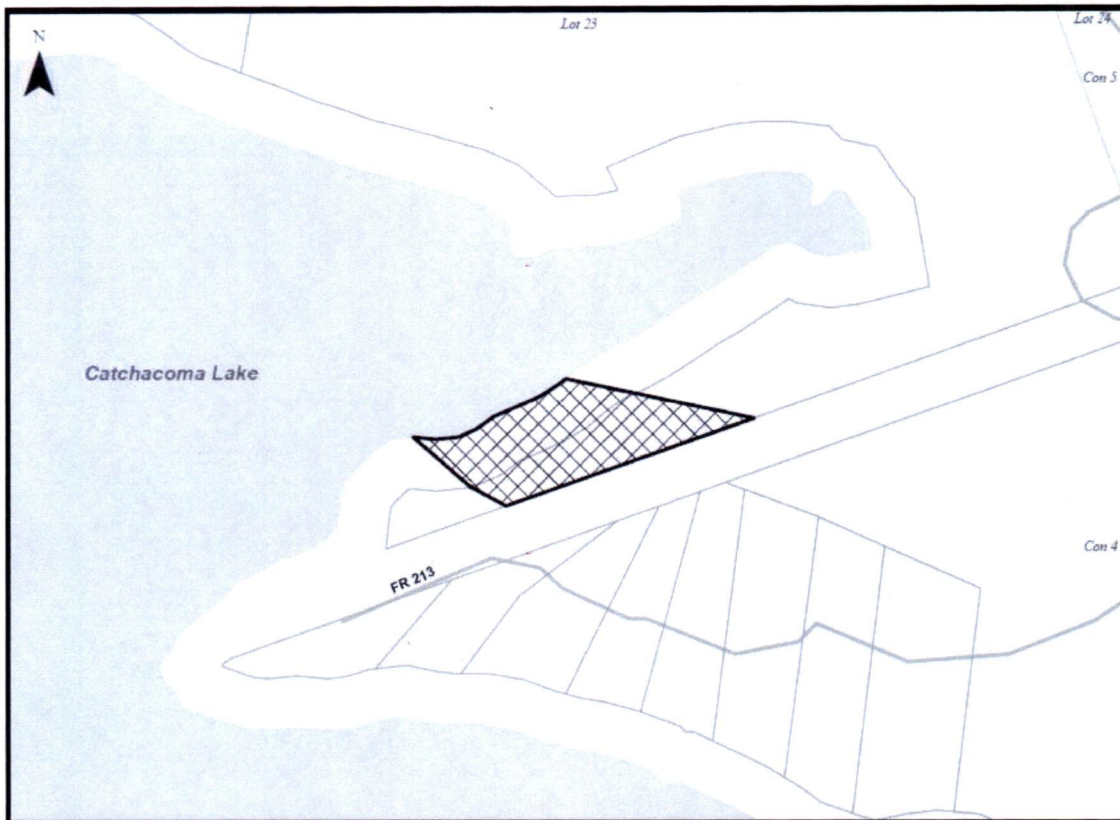
Schedule A-1

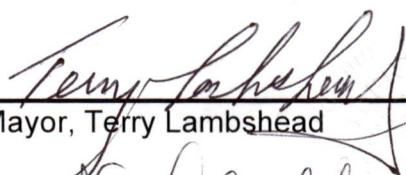
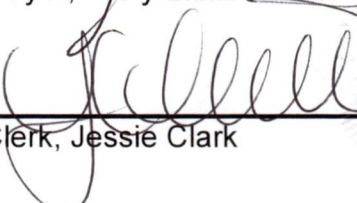
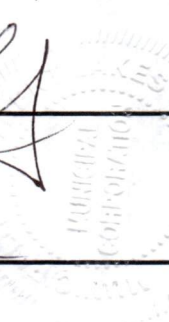

 Lands to be rezoned from the 'Shoreline Residential-Private Access (SR-PA) Zone' to the 'Shoreline Residential-Private Access Exception 125 (SR-PA-126) Zone'

<p>Schedule "A" to By-law No. B2024-065</p> <p>Lot 23, Concession 5 and Part Road Allowance in Front of Lot 23 Concession 5, Part 1 & Part 2 Plan 45R-14893 (Harvey)</p>	<p>Schedule "A" to By-law No. B2024-065</p> <p>Passed this 6th day of August, 2024</p> <p> _____ Mayor, Terry Lamshead</p> <p> _____ Clerk, Jessie Clark</p> 
--	--